



New Court, Lansdown Road, Cheltenham, GL50

£230,000

🛏 1 🚿 1 🚗 1



- Over 65's
- One Double Bedroom apartment
- Modern Kitchen
- New Court development
- Grade II listed building
- Bath with separate shower
- Storage in hallway
- Montpellier district



Situated in the beautiful New Court's Grade II listed building, this delightful one-bedroom flat offers a blend of historic charm and modern living for those aged 65 years and over.



GROUND FLOOR
552 sq.ft. (51.3 sq.m.) approx.

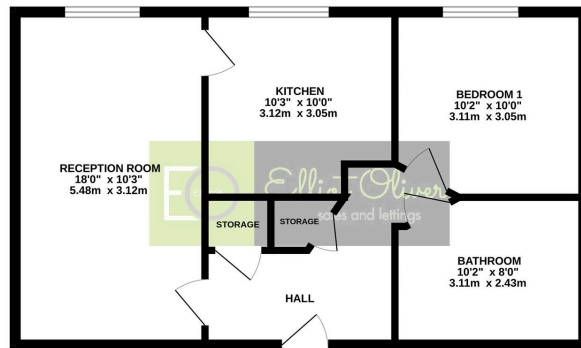

TOTAL FLOOR AREA: 552 sq.ft. (51.3 sq.m.) approx.
While every attempt has been made to ensure the accuracy of the figures contained here, measurements of floor, ceiling, rooms and any other parts are approximate and no responsibility is taken for any error, omission or misstatement. This plan is for guidance purposes only and should not be used as a basis for any prospective purchase. The services, fixtures and appliances shown here are for information and no guarantee as to their operability or efficiency can be given.
Drawn with MetreX CAD2008

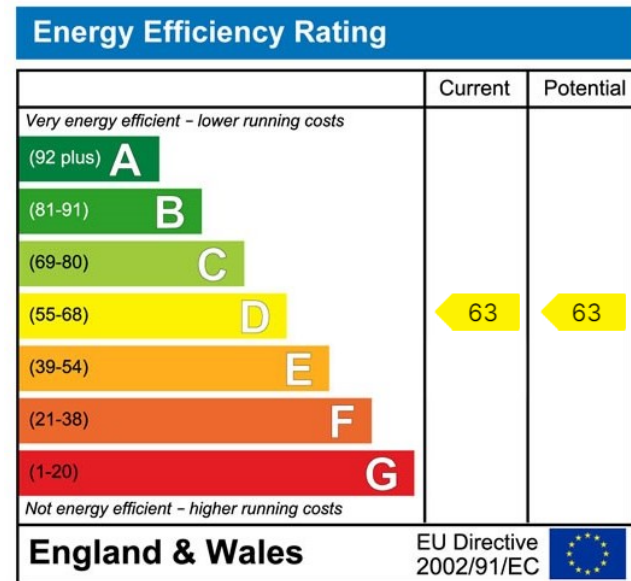

Elliot Oliver Sales
101 Promenade, Cheltenham GL50 1NW
01242 321091
www.elliottoliver.co.uk

